

2

NOTES: UNLESS OTHERWISE SPECIFIED:  
1. THIS IS A CAD GENERATED DRAWING. DO NOT REVISE MANUALLY.

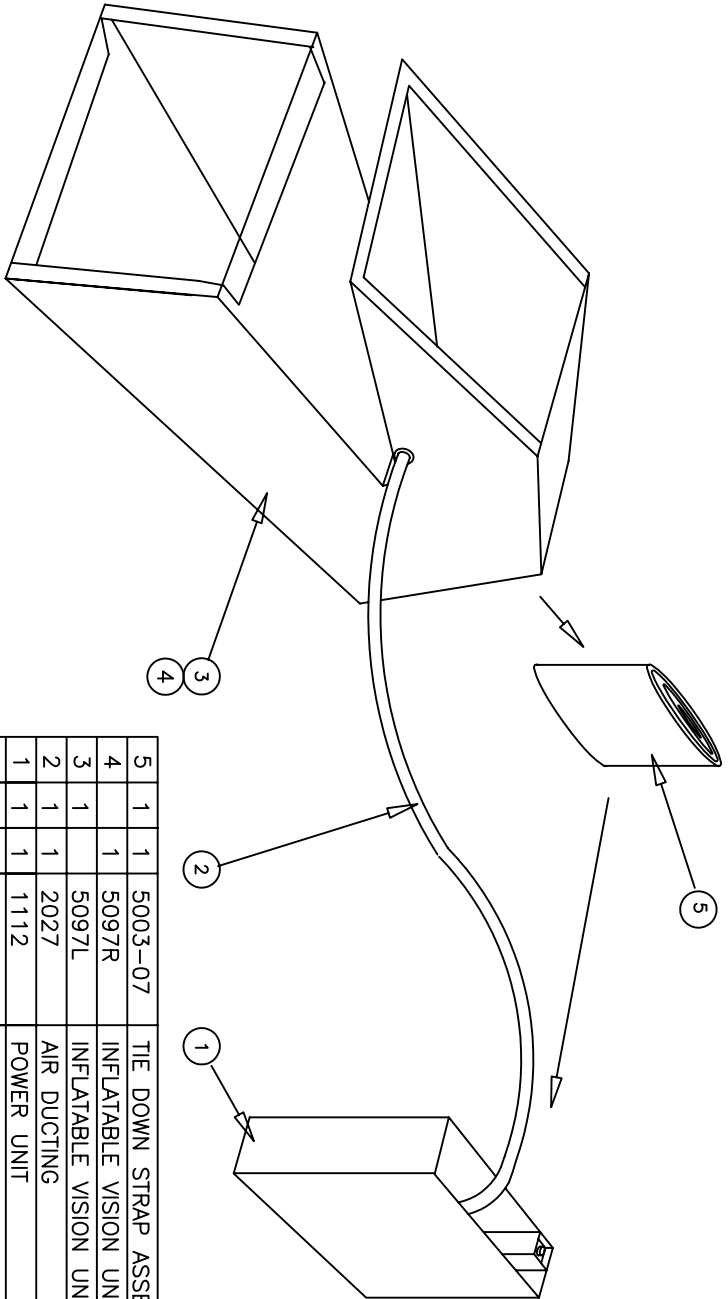

REVISIONS			
REV	DESCRIPTION	DATE	APPROVED
A	ADDED "STC" TO MODEL	01/15/01	HEW
B	MADE APPLICABLE TO 737-800	06/21/05	CBKW

1

ITEM NO.	QTY.	REV'D.	PART OR IDENTIFYING NO.	NOMENCLATURE OR DESCRIPTION	MATERIAL SPECIFICATION	NOTE
5	1	1	5003-07	TIE DOWN STRAP ASSEMBLY		
4	1	1	5097R	INFLATABLE VISION UNIT		
3	1	1	5097L	INFLATABLE VISION UNIT		
2	1	1	2027	AIR DUCTING		
1	1	1	1112	POWER UNIT		
		X	107STC-122	EVAS, RIGHT		
		X	107STC-121	EVAS, LEFT		

PARTS LIST

UNLESS OTHERWISE SPECIFIED: DIMENSIONS ARE IN INCHES. TOLERANCES: FRACTIONS ± .005 DECIMALS ± .005 ANGLES ± .5°

MATERIAL:	VARIOUS	CONTRACT NO.	
FINISH:	BOEING	APPROVALS	DATE
APPLICATION	USED ON	CHECKED:	01/03/00
		ENGR:	
		Q.A.:	
		SCALE	NONE
		LOCATION:	6007001B
		SHEET	1 of 1

THE INFORMATION CONTAINED HEREIN IS PROPRIETARY AND CONFIDENTIAL TO VISION SAFE CORP., AND SHALL NOT BE DISCLOSED OR COPIED, IN WHOLE OR IN PART WITHOUT THE WRITTEN CONSENT OF VISION SAFE CORP.

2

1

A

B

A

B