

NOTES: UNLESS OTHERWISE SPECIFIED:
1. THIS IS A CAD GENERATED DRAWING. DO NOT REVISE MANUALLY.

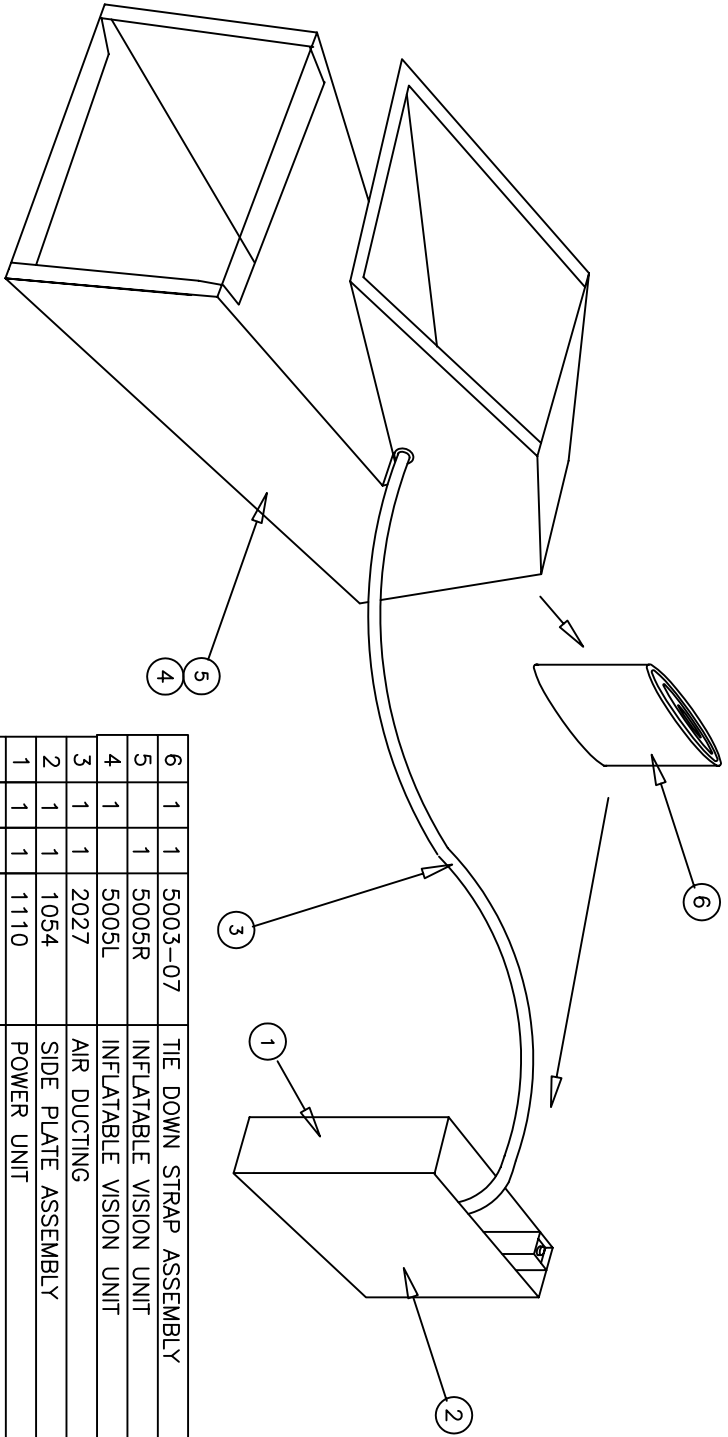

REVISIONS			
REV	DESCRIPTION	DATE	APPROVED
A	MADE APPLICABLE TO -400 & -500	06/28/03	HEW

ITEM NO.	QTY. REQ'D.	PART OR IDENTIFYING NO.	NOMENCLATURE OR DESCRIPTION	MATERIAL SPECIFICATION	NOTE
6	1	5003-07	TIE DOWN STRAP ASSEMBLY		
5	1	5005R	INFLATABLE VISION UNIT		
4	1	5005L	INFLATABLE VISION UNIT		
3	1	2027	AIR DUCTING		
2	1	1054	SIDE PLATE ASSEMBLY		
1	1	1110	POWER UNIT		
	X	107-028	EVAS, RIGHT		
	X	107-027	EVAS, LEFT		

PARTS LIST		CONTRACT NO.		VISION SAFE CORPORATION	
UNLESS OTHERWISE SPECIFIED: DIMENSIONS ARE IN INCHES. TOLERANCES: FRACTIONS ± .005 DECIMALS ± .03 ANGLES ± .5		P.O. BOX 5011, KANE OHE, HI 96744-5011 (USA)		MODEL 107-027 & 028 EVAS	
MATERIAL:		APPROVALS	DATE	BOEING 737-300, 400 & 500	
FINISH:		DRAWN: HEW	07/09/02	BOEING 737-300, 400 & 500	
DO NOT SCALE DRAWING		CHECKED:		SCALE NONE	
		ENGR:		LOCATION: 6085001A	
		Q.A:		SHEET 1 of 1	

THE INFORMATION CONTAINED HEREIN IS PROPRIETARY AND CONFIDENTIAL TO VISION SAFE CORP., AND SHALL NOT BE DISCLOSED OR COPIED, IN WHOLE OR IN PART WITHOUT THE WRITTEN CONSENT OF VISION SAFE CORP.

BOEING	737-300,
	-400, -500
6086	USED ON
	APPLICATION

2

1

B

B

A